

Installation  
instructions

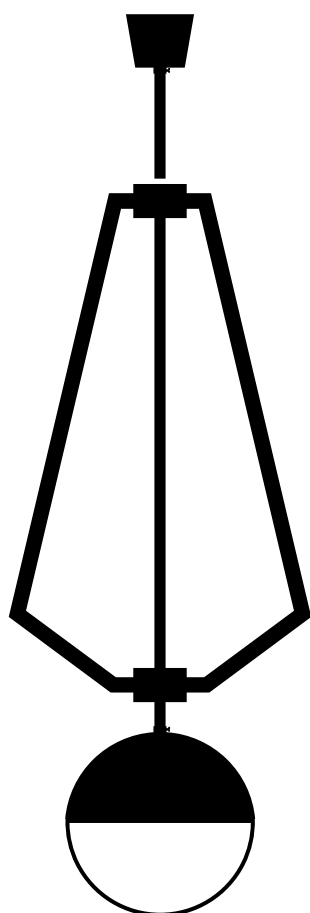

### Instructions

- Must be installed by a professional
- Handle items carefully
- Use appropriate screws and equipment
- Wear gloves during installation

### Assembly time

1h00

### Number of people required

2

**1**

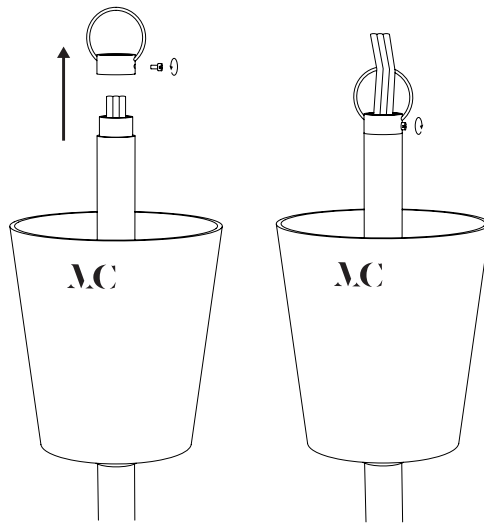

Unscrew the hook and insert the wires before screw it back.

**2**

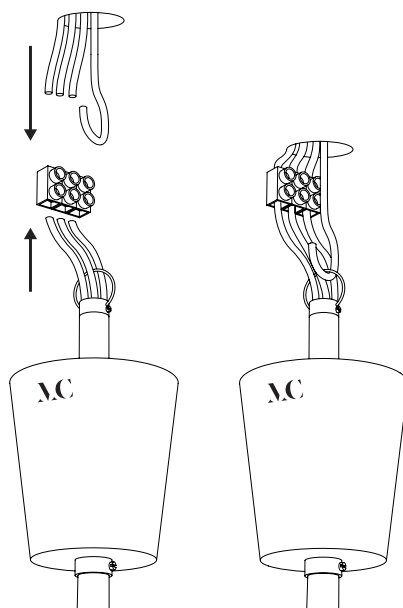

Connect the wires to the mains after setting up the hook.

---

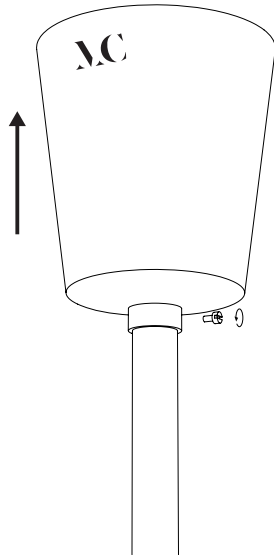
**3**

Pull up the thread guard after  
unscrewing the ring's screw.

---

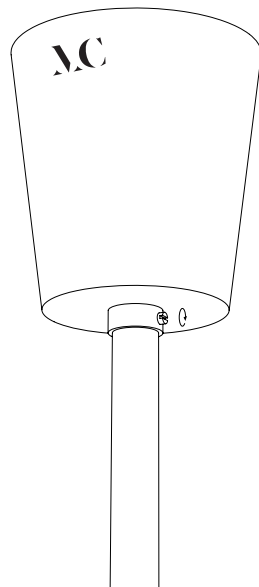
**4**

Once in place, screw it back.

**1**

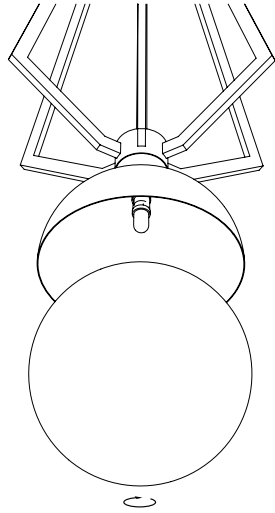

In the case of light bulb replacement. Unscrew the glass globe.

**2**

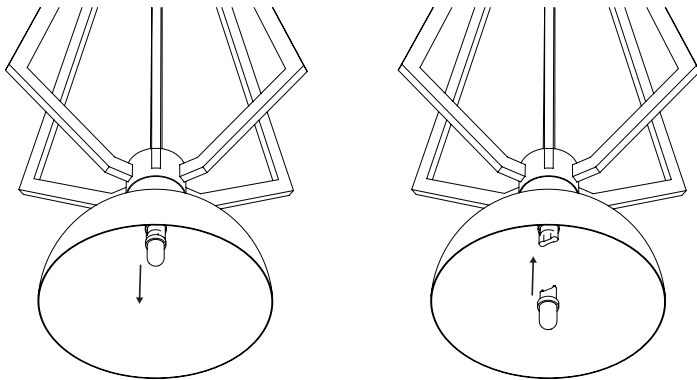

Insert the light source into the base

**3**

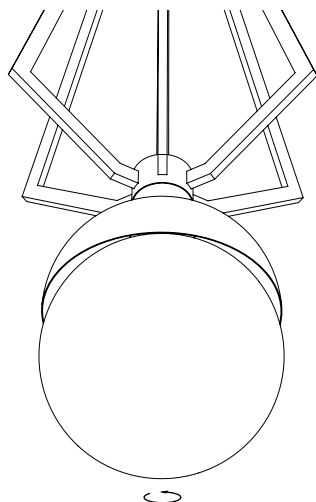

Screw the glass globe up to the resistor.  
Beware ! Do not tighten stronger than natural resistance